



Playhouse Theatre has been part of the Perth landscape for so long, its audiences have a proprietorial interest in the building with its intimate and comfortable spaces so famous for after-show parties.

Located in the heart of Perth's central business district, Playhouse Theatre has always been a popular choice for those wanting a city location that is both comfortable and affordable for conferences, seminars, sundowners or award ceremonies.

Though built in 1956 as home for Perth's first professional theatre company, the theatre has since been extensively re-modelled. Playhouse Theatre is a venue with a difference.

### **Main Auditorium**

The Main Auditorium has a total seating capacity of 427 – 189 in stalls and 238 in the dress circle. The stage is 8.8 metres deep and 10.2 metres wide, with an additional 3 metres of wing space on each side. The seating is raked, which gives the auditorium its intimate feeling while also ensuring clear sight-lines to the stage for every delegate.

### **Main Foyer**

Perhaps not a typical theatre foyer, this area is the cosy gathering point for interval refreshments and seminar registrations. Despite a slightly sloping floor, it is a successful gallery area with picture hanging rails and is suitable for poster and product displays.

### **Theatre Bar**

Patrons can enjoy refreshments before and after performances in the fully-licensed bar upstairs on the first floor. A contemporary bar area, with a slightly 'retro' feel, that is available for hire by private and corporate clients. Please note that there is no disabled access to this area.

### **Function Room**

The recently completely-refurbished Function Room is a private room ideal for board meetings, theatre-style seminars, VIP dinners and cocktail receptions. The room overlooks St Georges Terrace and Government House, features ADSL Internet connection, and its very own mini-kitchen that includes a refrigerator and hot urn. Situated on the top floor, this room does not have disabled access.

FROM AN INTIMATE COCKTAIL PARTY TO A WEEK LONG  
CONFERENCE, OUR CATERING AND FUNCTION PROFESSIONALS  
CAN ARRANGE ALL YOUR FOOD AND BEVERAGE REQUIREMENTS.

### Auditorium & Foyer Plan - Ground Floor

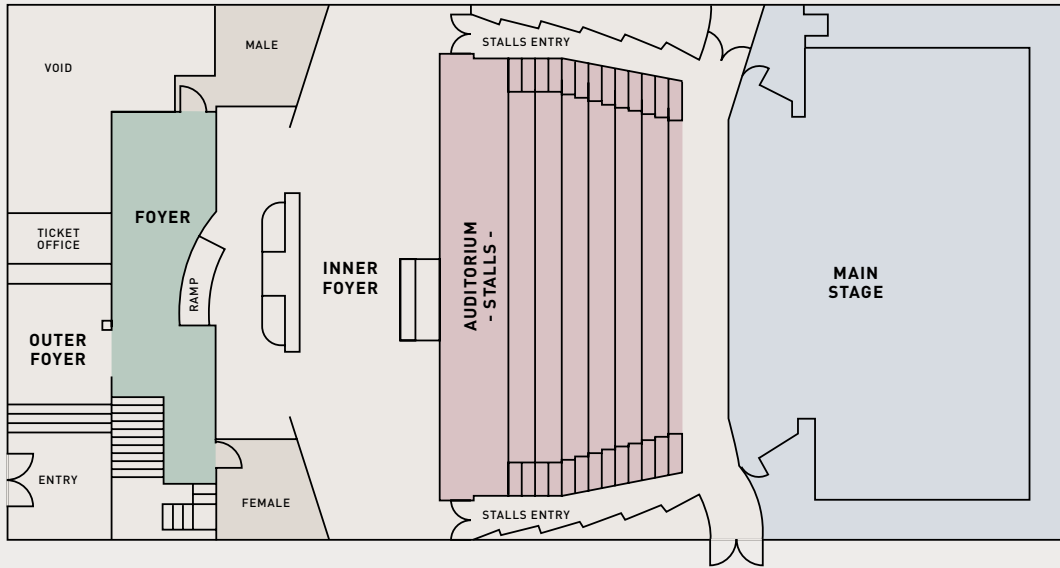

### Theatre Bar Plan - First Floor

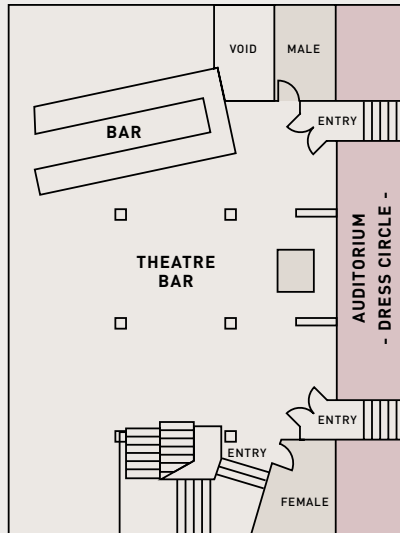

### Function Room Plan - Second Floor

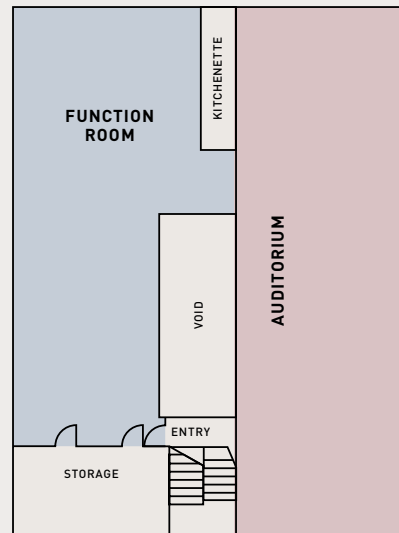

PLAYHOUSE THEATRE	DIMENSION (M)	AREA (M <sup>2</sup> )	CEILING HEIGHT (M)	Theatre	Cocktail	Dinner	Boardroom
Auditorium				427	-	-	-
Main Stage	12.7 x 16.8	130	5.1	80	110	90	-
Main Foyer	sectioned	128	2.1 to 2.7	-	120	-	-
Theatre Bar	10.7 x 8.5	100	2.3	40	100	50	20
Function Room	14 x 4	62	2.6	40	60	40	30

NB Dinner & Cocktail capacities will reduce where a dance floor is required.  
Area (M<sup>2</sup>) indicates useable floor space.

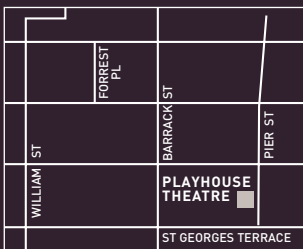

Playhouse Theatre is located on the main Perth City bus routes on St Georges Terrace and nearby Barrack Street, just a ten minute walk from the Perth Railway Station and in close proximity to a number of public car parks. ACROD parking bays are also available.

The theatre has an infrared hearing system for the hearing impaired and is equipped with wheelchair access to the Main Auditorium via the laneway on the right hand side of the building, with special allocated seating in the auditorium. We request prior notification of all attendees who have special needs.

#### Playhouse Theatre

3 Pier Street Perth, Western Australia. All correspondence: PO Box Y3056 East St Georges Tce, Perth WA 6832.  
Function enquiries: T 08 9231 9941 F 08 9221 0775.

[www.playhousetheatre.com.au](http://www.playhousetheatre.com.au)